

Requirements for CAD Review Approval

- 1 cad file attached to an email, showing only:
 - existing water and sewer utilities that are being tied into
 - proposed utilities (line work, valves, manholes, fire hydrants, reducers, etc.)
 - property/right of way lines
 - grid ticks
 - labels

Please no x-refs or surfaces/topography. Do not send multiple files in a folder or zip file, they will be returned and you will be asked to send a single file back. Layouts are un-necessary as well, all work should be in model space, and file should be very basic.

- All proposed utility line work and structures must be present and match approved plans in WSSC ePlan Review – ProjectDox.
- All line work must be in the correct geodetic location, and datum (NAD83) so proposed work can be overlaid and used to update our GIS map.
- WSSC Layer naming standards must be utilized so your cad file can be run through a layer translator. (see excel file located on the Land Services Section page under the Business & Construction tab on the WSSC Water home page for layer list)
- In the subject line of your submittal email please write your contract number, and make sure to CC your project manager.

Any and all questions can be sent to CADREVIEW@wsscwater.com

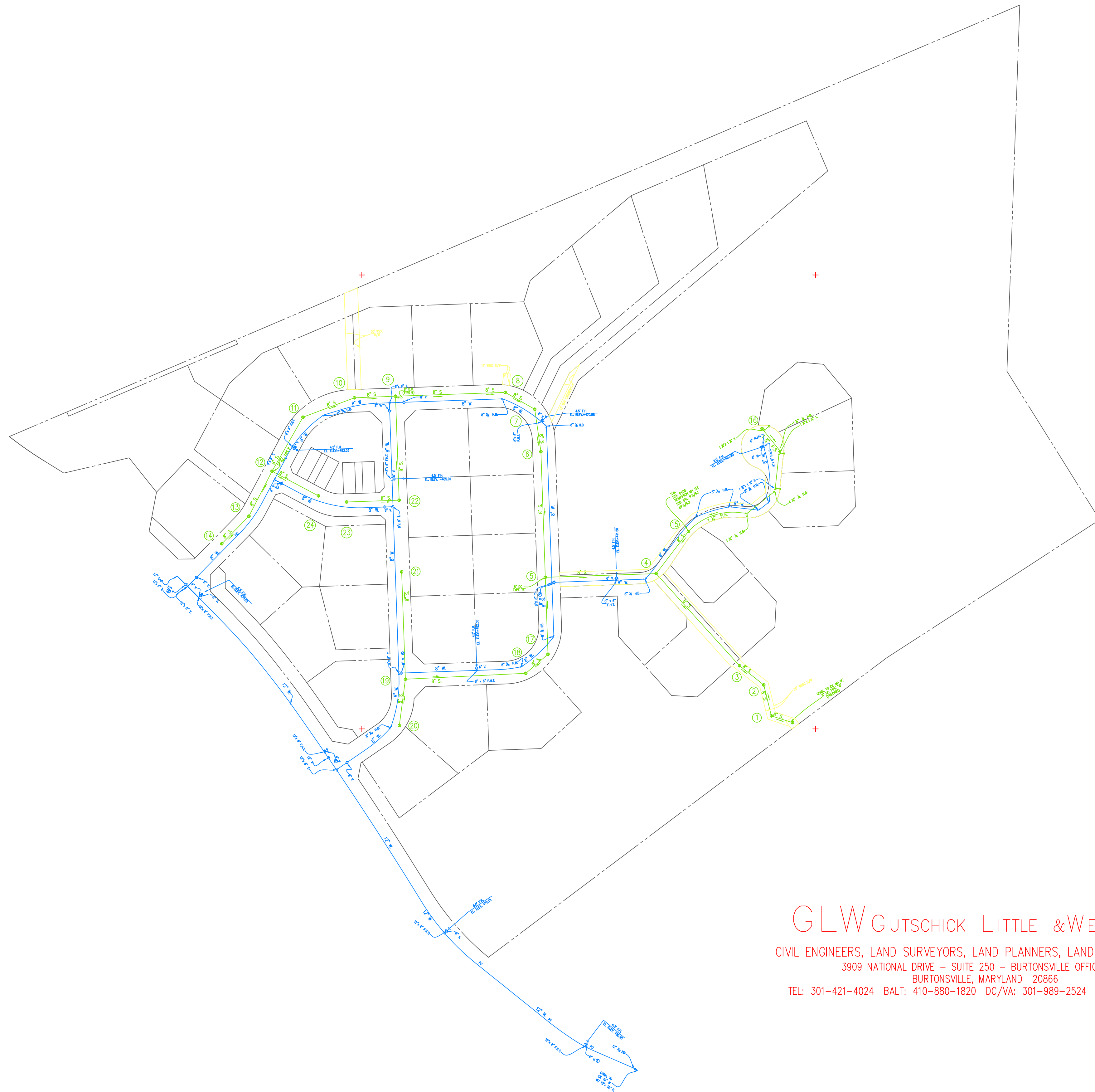

GLW GUTSCHICK LITTLE & WEBER, P.A.
 CIVIL ENGINEERS, LAND SURVEYORS, LAND PLANNERS, LANDSCAPE ARCHITECTS
 3909 NATIONAL DRIVE - SUITE 250 - BURTONSVILLE OFFICE PARK
 BURTONSVILLE, MARYLAND 20866
 TEL: 301-421-4024 BALT: 410-880-1820 DC/VA: 301-989-2524 FAX: 301-421-4186