

Takoma Park Water and Sewer Main Replacement

**September 18, 2017
Meeting Handout**

Spring 2017 Alignment Investigation Results

- Anticipated Tree Impacts
- Front yard gravity sewer alignment, with laterals around the sides of homes, determined infeasible

“Trenches installed parallel to footings shall not extend below the 45-degree (0.79 rad) bearing plane of the footing or wall.”

-- International Plumbing Code (2012)

6617-6705 Eastern Avenue – Homeowner Requirements

- Signed easement document for backyard installation of sewer
- Signed Right-of-Entry for installation of water

Backyard Gravity Alternative



- Utilizes existing house connections
- 20-foot permanent easement
- Horizontal Directional Drilling
- Temporary easements TBD

Backyard Gravity Alternative – Typical House Connection

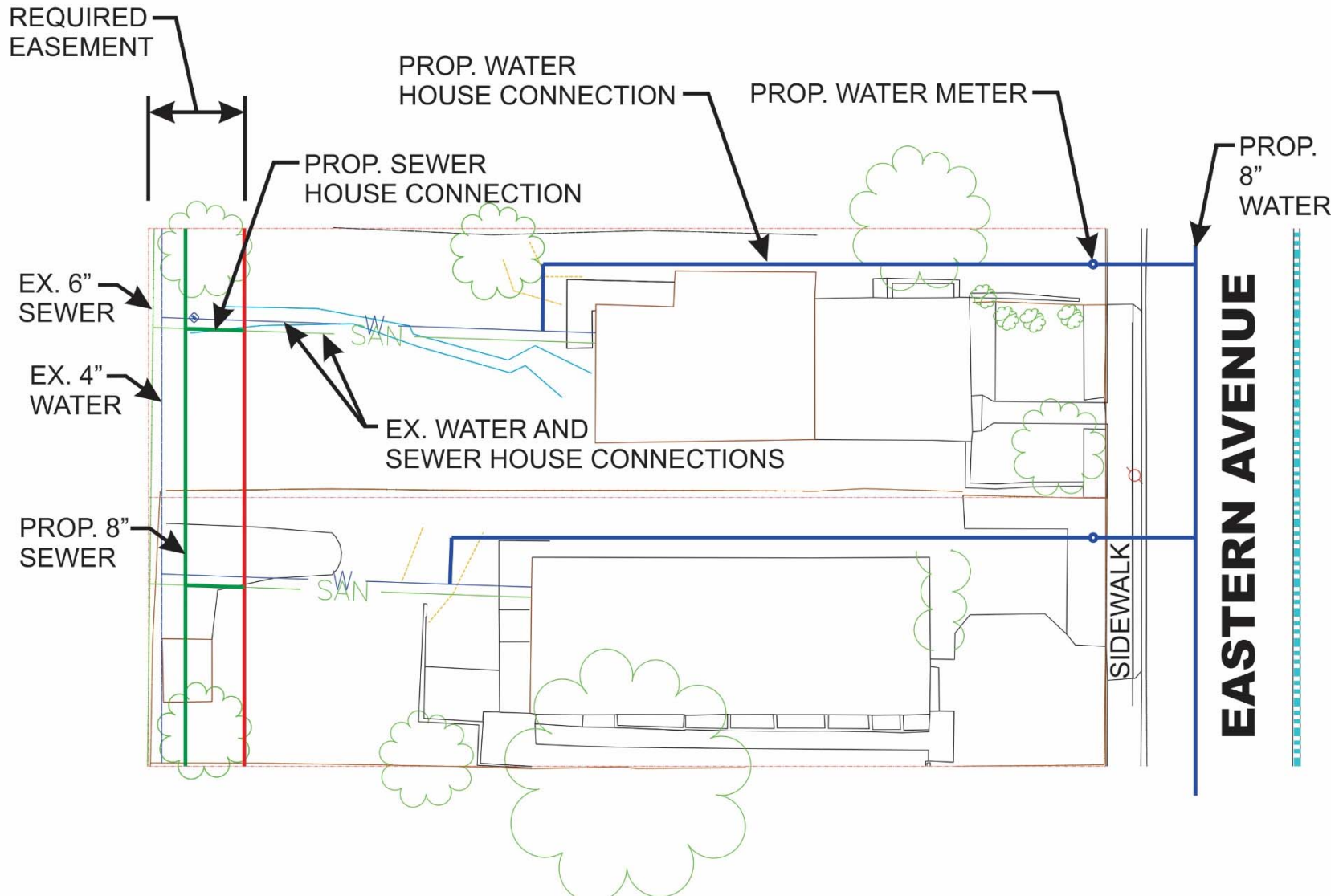

Backyard Gravity Alternative – Typical House Connection

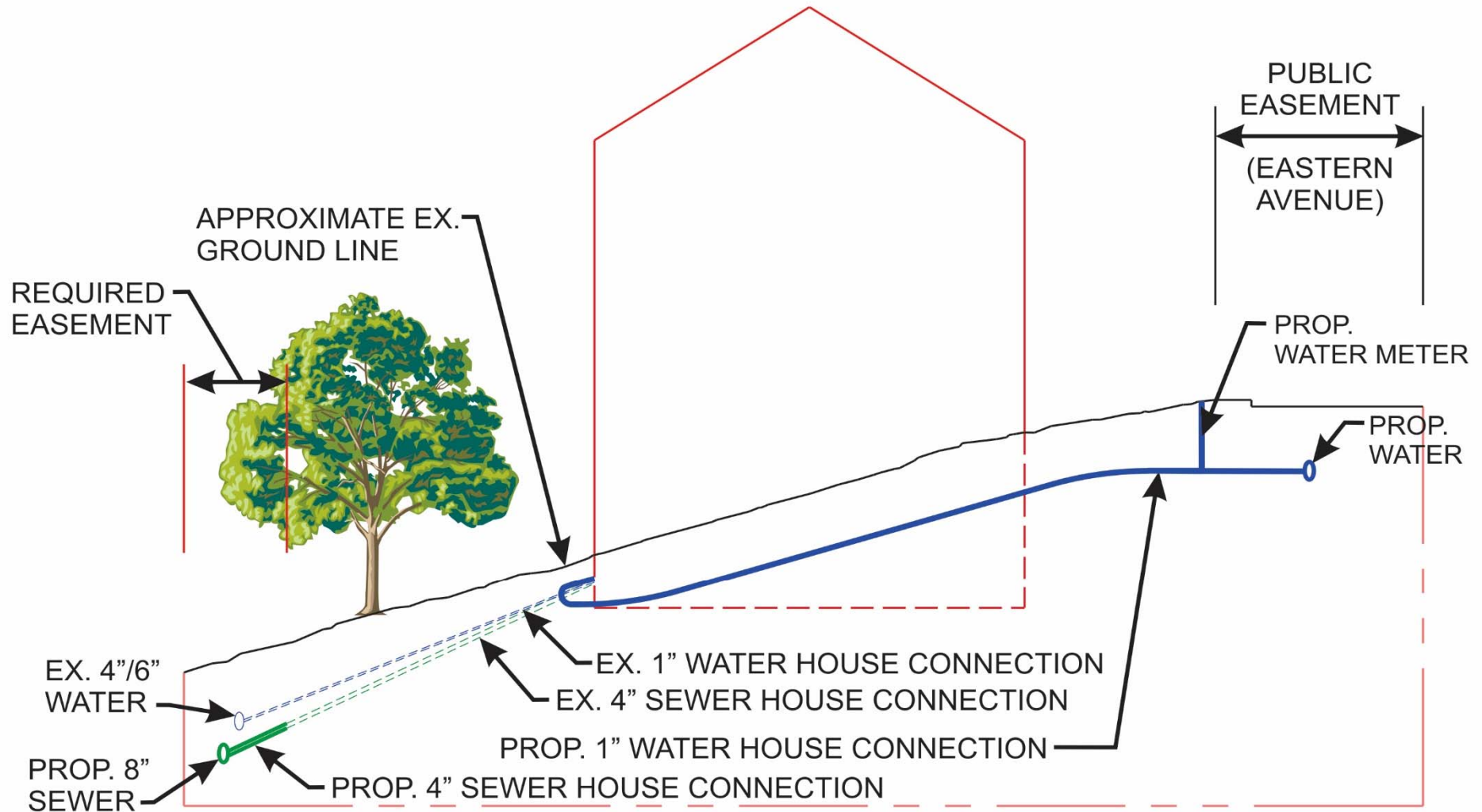

Backyard Gravity Alternative – Temporary Easements

- WSSC will pursue temporary easements at the following properties to create an access pathway to feed pipe material to the drilling pit:

- 57 Walnut Avenue
- 6761 Eastern Avenue

*pipe feeding path
shown in red



Homeowner Requirements

- Signed easement document for installation of sewer
- Signed Right-of-Entry for installation of water

Front Yard Pressure Sewer Alternative



- New sewer laterals installed around the sides of homes
- Pressurized sewer system means shallow excavation
- Grinder pump system installed at each home

Front Yard Pressure Sewer Alternative – Typical House Connection

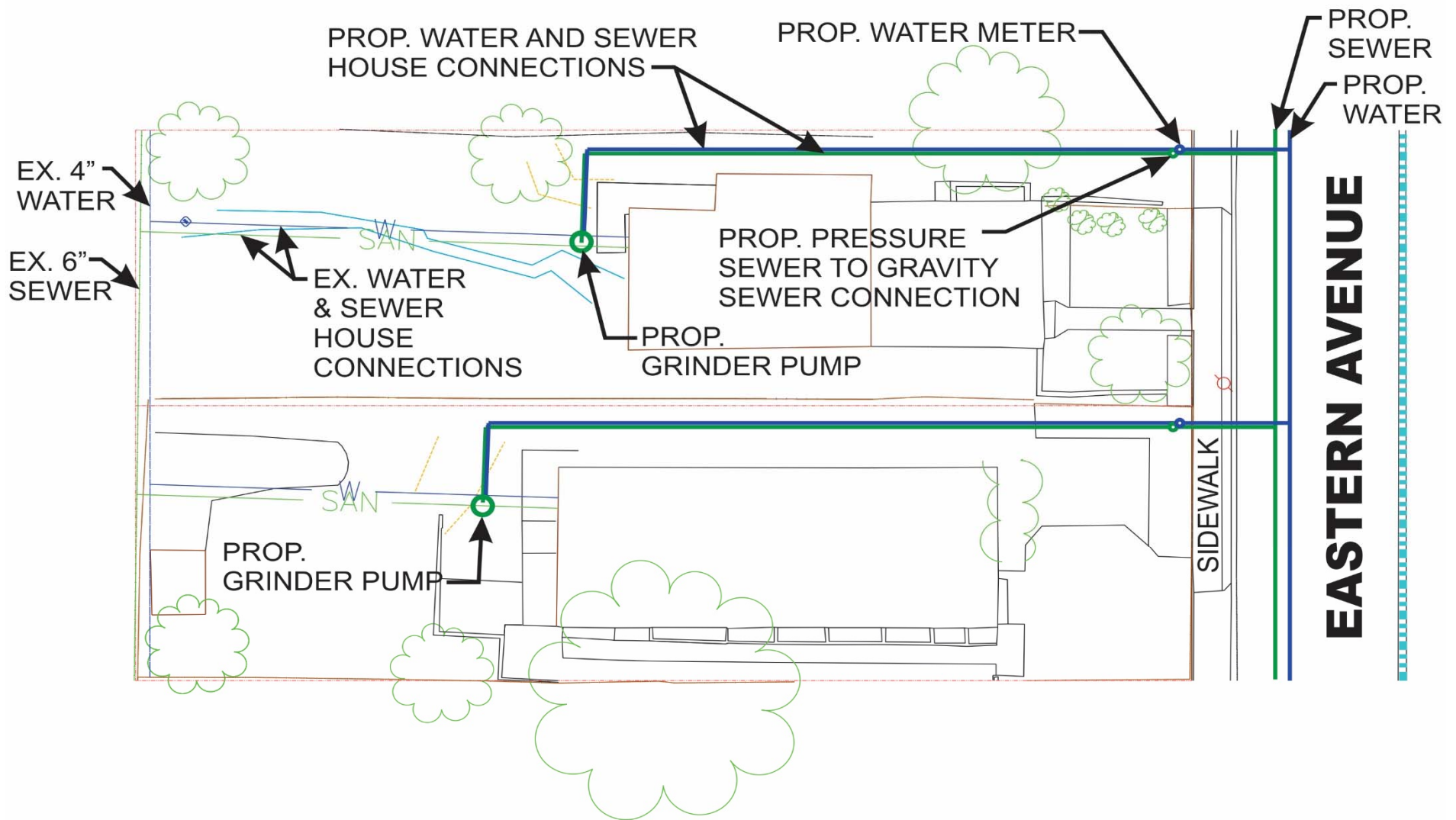

Front Yard Pressure Sewer Alternative – Typical House Connection

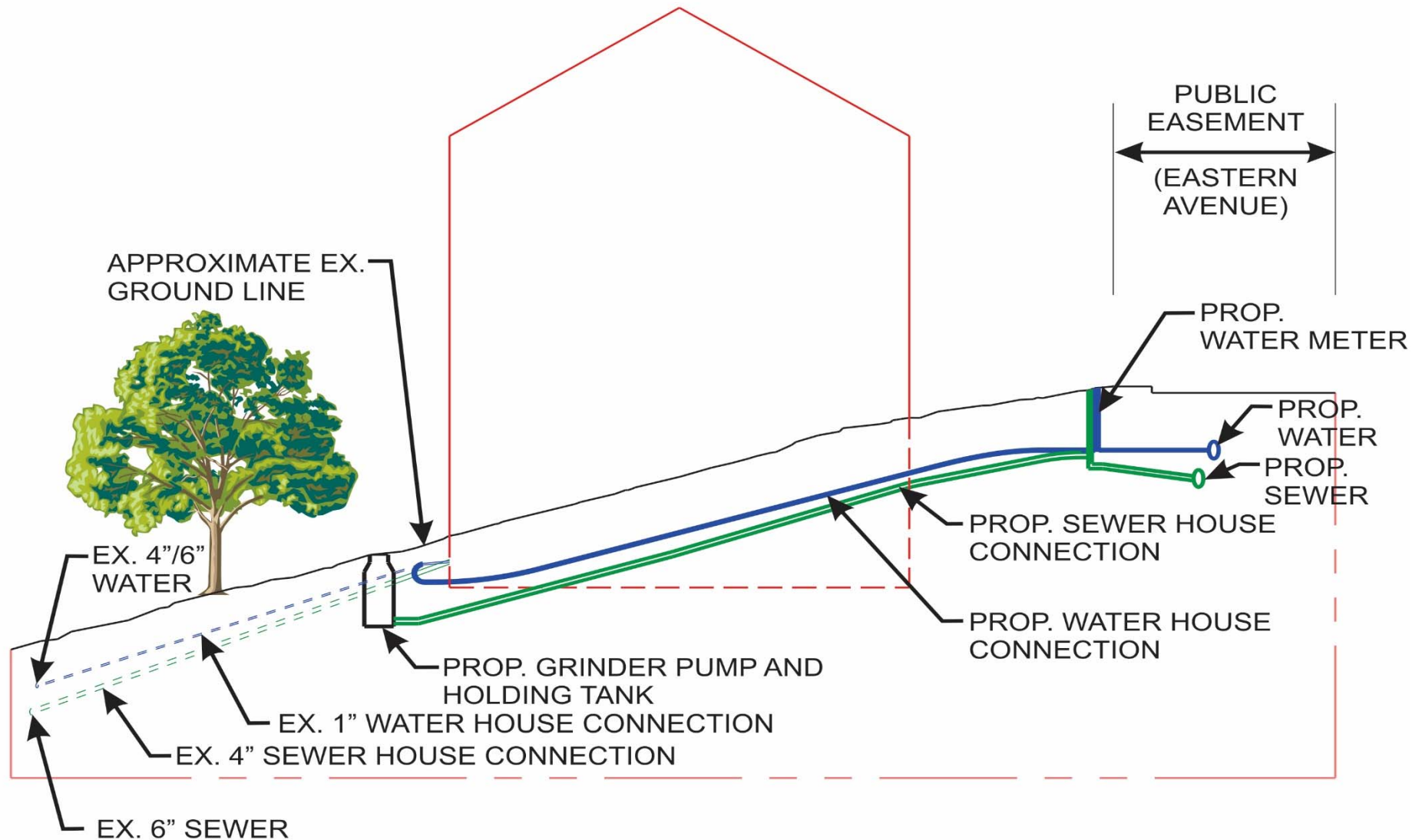

Homeowner Requirements

- Signed Right-of-Entry for installation of water, sewer, and grinder pump
- Homeowner has maintenance responsibility for the grinder pump after 12-year warranty period

Front Yard Gravity Sewer Alternative



- New sewer service exit point at front of home
- Exit point installed by private plumbing contractor

Front Yard Gravity Sewer Alternative – Typical House Connection

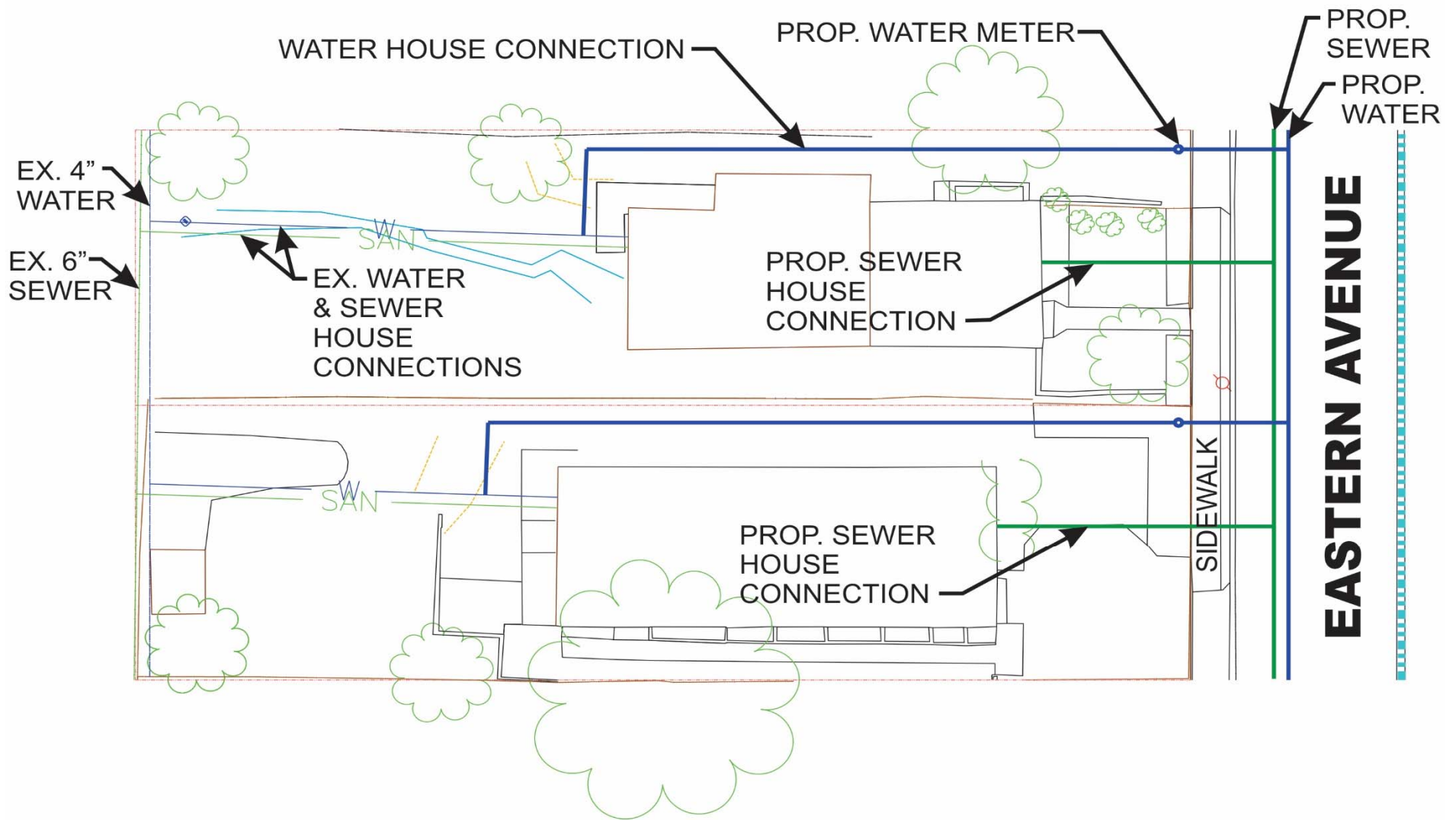

Front Yard Gravity Sewer Alternative – Typical House Connection

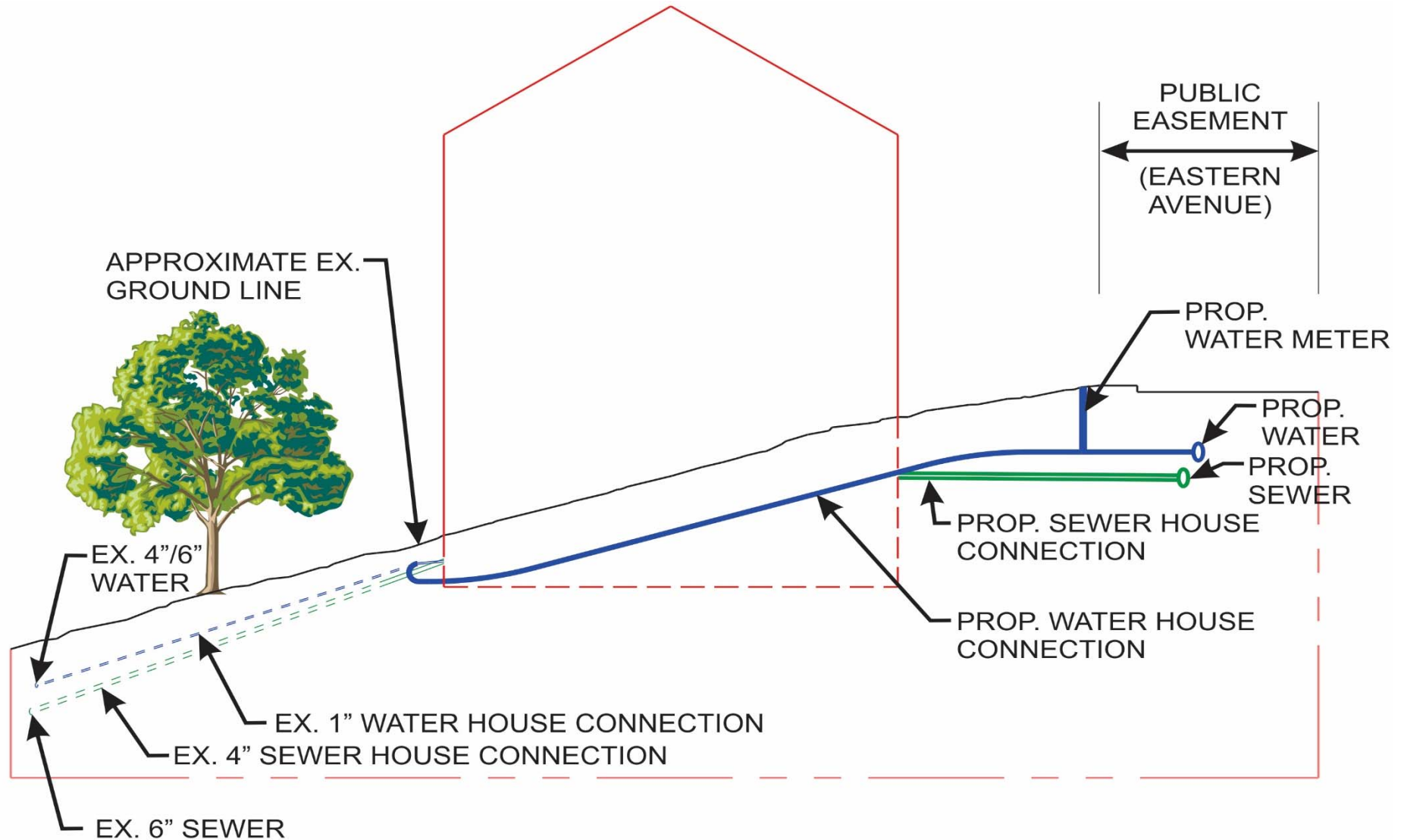

Estimates for Renovation

| Plumbing Item | Price Estimate |
|----------------------------|---|
| Hung building drain | \$5800.00 |
| Sewer Ejector install | \$9800.00 |
| Sewer -2- 4 Ft deep (A) | \$3800.00 |
| Sewer -4-6 Ft deep (B) | \$5200.00 |
| Sewer -6-10 Ft deep (C) | \$7200.00 |
| Total without ejector pump | A=\$9,600.00 B=\$11,000.00 C=\$13,000.00 |
| Total with ejector pump | A=\$19,400.00 B=\$20,800.00 C=\$22,800.00 |

*Prices do not include renovation of impacted interior rooms

Homeowner Requirements

- Signed Right-of-Entry for installation of water and sewer
- WSSC will not reimburse homeowners for private, in-home renovation
- Homeowner required to complete renovation and tie into the new sewer main