

BOTTOM VIEW  
OF COVER

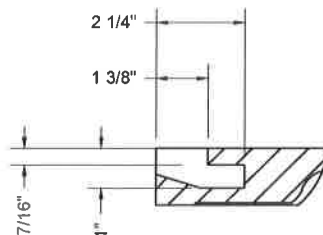

PICKHOLE  
DETAIL

APPROXIMATE WEIGHT OF  
FRAME = 130 LBS

APPROXIMATE WEIGHT OF  
HEAVY DUTY COVER = 75 LBS

CASTINGS SHALL CONFORM TO  
AND BE MANUFACTURED IN  
ACCORDANCE WITH THE  
REQUIREMENTS OF AASHTO  
STD M306, LATEST REVISION

MATERIAL SPECIFICATION:  
GRAY IRON ASTM A48 CL35B

APPLICABLE STOCK NOS.  
5680-9011-2 ) SEE P&M  
5680-9012-0 ) 10.4A  
5680-9021-1  
5680-9013-8

SEE DETAIL P&M 10.4b  
FOR CONTINUATION

WASHINGTON  
SUBURBAN  
SANITARY  
COMMISSION

REVISIONS:

APPROVED: *3/17/16*  
*[Signature]*

MATERIAL AND SERVICES GROUP LEADER

PROCUREMENT AND MANUFACTURING DETAIL

HEAVYWEIGHT MANHOLE  
FRAME & COVER

P&M  
10.4b1